



GeoWarehouse[®]

POWERED BY TERANET

Property tools that make **you** the expert.

Welcome

Welcome to GeoWarehouse, the ultimate solution for real estate industry professionals across Ontario. Our web-based, centralized property information platform provides you with state-of-the-art mapping and research tools, as well as professional reports, giving you the power to make informed decisions and stand out in your field.

With a GeoWarehouse subscription, you have access to a wealth of information at your fingertips, including property details, neighbourhood sales, and demographic reports, as well as exterior, aerial, and bird's eye view images of properties. You can also conveniently access POLARIS Parcel Registers*, instrument images, surveys, plans, MPAC Assessment reports, and more, all in one central location.

GeoWarehouse enhances your professional image and all reports are completely customizable to your subject property, making you the expert in your field. Discover the tools that will take your business to the next level with GeoWarehouse.



Product Spotlight

Property Report

GeoWarehouse subscribers can easily create comprehensive property reports that provide an overview of the property, property details from the Land Registry and includes demographics data, and more. There are three GeoWarehouse Property Report options to choose from when doing your due diligence.

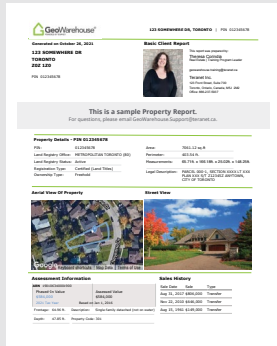

Basic Client Report

This Basic Client Report includes an Aerial and Street view of the property and the details pertaining to the land including lot size.



My Property Report

This all-in-one completely customizable report contains valuable information that includes property ownership and sales history data, imagery of the subject property, estimated market value, and more.



Client Report

The customizable Client Report includes private data such as legal description, owner names, market information and comparable sales data. This report also includes historical trends, average sales value, market turnover and more.

Product Spotlight

Parcel Register

Once you have pulled the GeoWarehouse Property Report through any of the available search tools, investing in a Parcel Register provides additional detail that helps you quickly validate and uncover any potential concerns with the subject property.

This powerful transactional report provides an in-depth look at a property's history, including ownership, transfers, encumbrances, liens, and more. In essence, having access to a Parcel Register* makes your due diligence process smoother. Some things it can help you identify are:

- By leveraging the information contained in the Parcel Register¹ you can validate if your client is the legal homeowner. This is particularly useful when you're working with a new client.
- You can also identify underlying issues instantly – like property liens exceeding the value of the property or odd transfers that can indicate fraud.
- You can see the mortgages currently registered against the title of the property. You can also identify potential problems when it comes to registered mortgages. For instance, the seller could have taken a mortgage that is not from a chartered bank, trust company, credit union, or a similar institution.
- You can also dig deeper into property details with Title Documents, including an Instrument Image² or Plan Images³, which is registered or deposited within the Land Registration System of Ontario. In addition, you also have access to the Image of the Survey Plan, Building Location Survey and other deposited plans provided by third-party surveying firms. These will help you easily acquire dimensions of property boundaries and structural elements of the land.

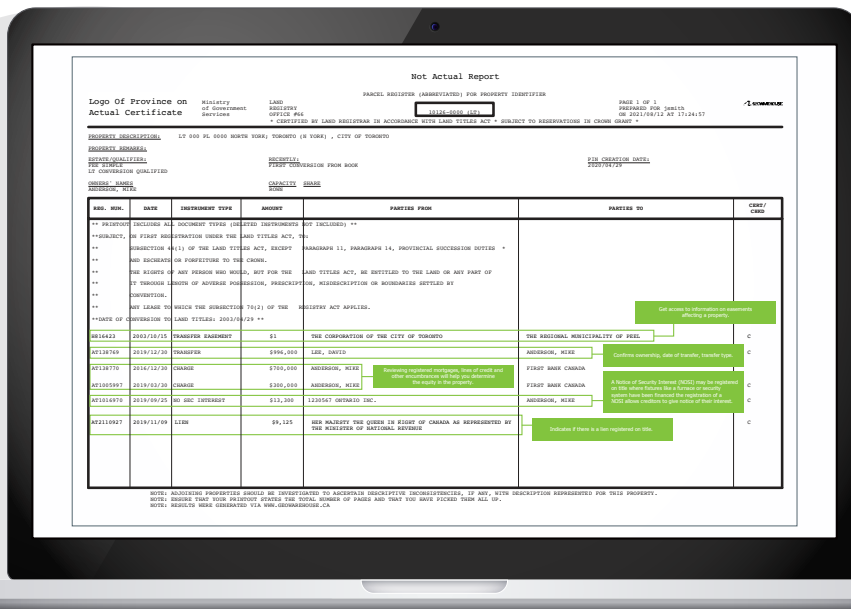

* An official product of the Ontario government pursuant to provincial land registration statutes and are available to purchase in the GeoWarehouse Store.

¹ The system of electronic land registration of Ontario was established pursuant to provincial land registration statutes.

² Electronic Land Registration Services Act.

³ For residential properties of four units or less. Not for vacant land.

Product Spotlight

Residential Relocation Reports

The Residential Relocation Reports provide a critical edge, giving you access to relocation data within their desired geographic options. The reports were created to help you with marketing and business growth plans. It also assists with educating clients to better understand the breakdown of real estate transactions occurring within specific geographic areas.

The new Entering Residential Relocation Reports are offered at three aggregate data levels:



FSA (Postal Code)



Municipality



Land Registry Office

Sample FSA (Postal Code) Report

These reports are available for purchase in the GeoWarehouse Store and in the Property Detail Report.

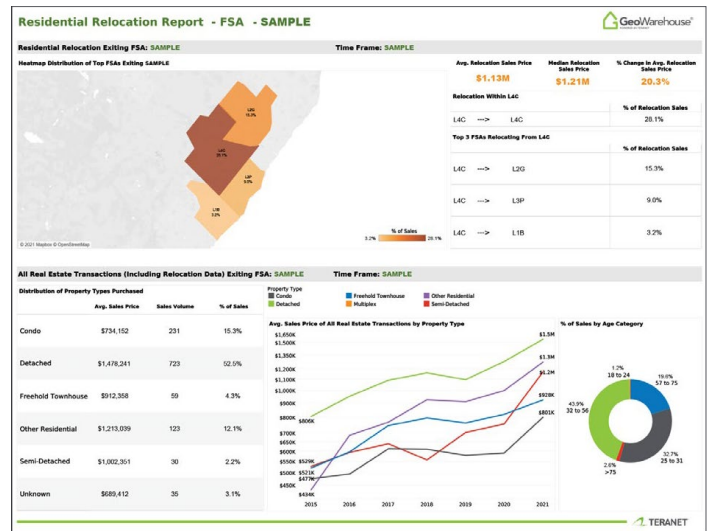
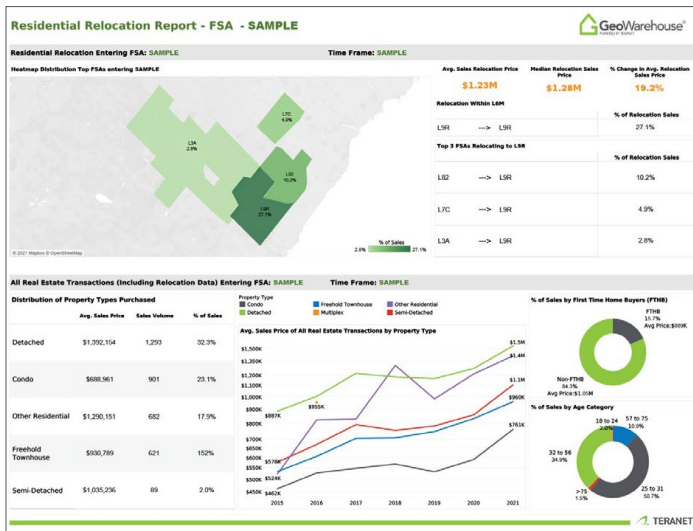

Product Spotlight

Heat Maps

The GeoWarehouse interactive heat map tool offers three layers of data that quickly and accurately show your residential real estate transaction information for any market in Ontario.

The data and analytics are powered by Teranet's authoritative, comprehensive land registry database to create a visual representation that makes researching various markets easier. The GeoWarehouse heat maps will help you distinguish the performance of different locations based on the various real estate metrics to better support you as you add value for your clients.



When you select the "Average Sales" layer, the map updates to show an overlay with the average sale price for the area in view.



When you select the "Growth Rate" layer, the map updates to show an overlay with percentage data for the area in view.



When you select the "Market Turnover" layer, the map updates to show an overlay with percentage of properties that have sold within that block to indicate the popularity of a given area.

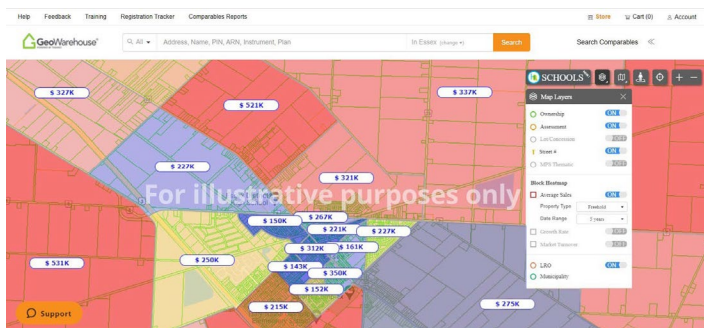

Freehold Average Sales Heat Map Sample

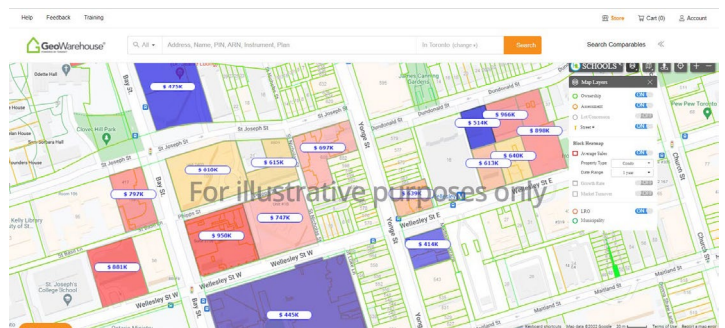

Condo Average Sales Heat Map Sample

We are continuously adding new features and functions to GeoWarehouse and the Heat Maps are just one of the many enhancements that have been added as of late.

*Each heat map layer allows to filter by property type using freehold or condo information.

Product Spotlight

GeoWarehouse® Property Insights Report

Date Report Generated: 10-27-2020

Property Address: 123 Main Street
Municipality: City of Toronto
Province: ON
Postal Code: M2H 1R8

PIN: 030200107
Legal Description: PT LT 11-12 PL 682 CITY EAST AS IN CA754734; T/W & S/T CA754734; CITY OF TORONTO



Last Sale Price: \$ 725,000
Last Sale Date: 6-26-2009
Real-Time AVM: \$ 1,414,600
AVM Date: 10-23-2020
AVM Range: \$ 1,284,836 - \$ 1,596,049
Ownership Type: Freehold
Lot Size: 589.0 m²

Title Check

Item	Results	Details
Active Mortgage	Yes	The records indicate that this property may have an Active Mortgage registered.
Recent Sales	No	The records indicate that this property may have not been recently transferred.
Prior Foreclosure	No	The records indicate a Foreclosure may not have been registered on this title within the past two transfers.
Vendor is a Corporation	No	The records indicate that the vendor may not be a corporation.
No concurrent Mortgage	No	The records indicate that property may have been recently transferred with a concurrent mortgage being registered.
Active Judgement	No	The records indicate an Active Judgement may not exist on title.
Active Caution	No	The records indicate an Active Caution may not exist on title.

The Teranet and gateway logo are trademarks of Teranet Inc. (Teranet).

Page 1 of 2

The Property Insight Report

This detailed Teranet Property Insight Report, available for purchase in the GeoWarehouse Store, provides users with all the knowledge they need to know about a property. This includes a trusted valuation using Teranet's AVM, helping support CMA development with a secondary unbiased opinion which is also used by Financial Institutions and Mortgage Professionals. This can also be used when making listing or bidding price decisions, and authoritative title check data that will alert you to potential fraud and encumbrances on title.

GeoWarehouse® Enhanced Comparable Report

Date Report Generated: 10-27-2020

Property Address: 123 Main Street
Municipality: City of Toronto
Province: ON
Postal Code: M2H 1R8

PIN: 030200107
Legal Description: PT LT 11-12 PL 682 CITY EAST AS IN CA754734; T/W & S/T CA754734; CITY OF TORONTO



Last Sale Price: \$ 725,000
Last Sale Date: 6-26-2009
Real-Time AVM: \$ 1,414,600
AVM Date: 10-23-2020
AVM Range: \$ 1,284,836 - \$ 1,596,049
Ownership Type: Freehold
Lot Size: 589.0 m²

Title Check

Item	Results	Details
Active Mortgage	Yes	The records indicate that this property may have an Active Mortgage registered.
Recent Sales	No	The records indicate that this property may have not been recently transferred.
Prior Foreclosure	No	The records indicate a Foreclosure may not have been registered on this title within the past two transfers.
Vendor is a Corporation	No	The records indicate that the vendor may not be a corporation.
No concurrent Mortgage	No	The records indicate that property may have been recently transferred with a concurrent mortgage being registered.
Active Judgement	No	The records indicate an Active Judgement may not exist on title.
Active Caution	No	The records indicate an Active Caution may not exist on title.
Active Liens	No	The records indicate an Active Lien may not exist on title.
Power of Sale	No	The records indicate a Power Of Sale document may not have been registered on this title within the past two transfers.
Unusual Discharge	No	The number of discharges registered in the period specified is less than or equal to the specified tolerance.
Frequency of Power of Sale in Area	No	This check indicates that no Unusual Discharges may recently have taken place.

The Teranet and gateway logo are trademarks of Teranet Inc. (Teranet).

Page 1 of 4

The Enhanced Comparable Report

The Comparable Sales Report provides insights about comparable sales in the neighbourhood where the property is located. As the only authoritative single source for all real estate transactions in Ontario, this report will include Sale by Owner, Exclusive sales, builder sales and transactions that were completed by real estate professionals of another board.

Product Spotlight

PYB (Protect Your Boundaries)

With the GeoWarehouse and Protect Your Boundaries (PYB) partnership, you can access the PYB's easement counter technology that will enable a new Easement Indicator in the solution through the GeoWarehouse Property Report. This technology will notify GeoWarehouse users of all easements that affect each and every property in Ontario.

In addition to the new Easement Indicator technology, real estate, and land professionals will now be able to invest in PYB's Buyer's Reports, Seller's Reports, and Easement Reports through the GeoWarehouse Store. These reports summarize key information regarding the easements from official land registry records into a simple report - allowing you to remain the expert in the transaction.



Product Spotlight

HoodQ™ Neighbourhood & School Catchment Reports/Mapping

Deep dive into the details of a particular address, including nearby schools and their catchment areas, parks & recreation, transit, safety, and retail locations.

HoodQ Address Report

- One page report highlighting the address' best features
- Schools-including designated catchment schools
- Parks and rec facilities
- Transit-street and rail
- Safety and more...

HoodQ Detailed Report

- 8 to 10-page detailed reports
- Schools - including designated catchment schools
- Parks and rec facilities
- Transit, safety, and more
- Includes a full-color map

HoodQ School Report

- One page report highlighting school information
- Public and Catholic schools - both designated catchment schools and other local schools
- Alternative and special education schools
- Private schools

HoodQ School Catchment Mapping

- Included in your subscription, you can easily and quickly identify the school catchment area for both Public and Catholic schools, where available
- Use the GeoWarehouse Map function to view your subject property's catchment area



Training Sessions

GeoWarehouse is continually evolving and we want to ensure you are maximizing the platform to its fullest! We offer a variety of training resources to help you stay up-to-date with how GeoWarehouse can help you throughout the real estate transaction.

In addition to the four core courses, we offer five 30-minute Lunch & Learn sessions, to help you conduct your due diligence.



All About GeoWarehouse

Duration: 1.5 hours

In this webinar you will learn about all of the features available in your GeoWarehouse subscription.



Tips & Tricks

Duration: 1 hour

In this webinar, we will explore the top tips & tricks and best practices for using GeoWarehouse for both residential and commercial properties.

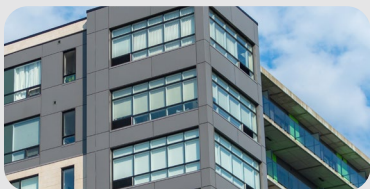

All About Condos

Duration: 1 hour

In this webinar, we will explore all of the unique features related to Condo type properties.



PDF Reports

Duration: 1 hour

In this webinar, we will explore how to generate and customize the PDF Property Report, Comparable Sales Report & Client Report.

Lunch & Learn Webinars

Other sessions we offer: Title Documents, Protect Your Boundaries, Teranet Property Insights Report, Hood Q Neighbourhood and School Catchment Reports.



**Click Here
or Scan
to Register
Today!**



Become a Teranet Insider

What is an Insider?

We've combined the words **Insight** and **Insider** to create a unique name for our community members. As a part of our community, you have inside access to our roadmaps, our goals, our objectives and our innovation journey. As part of our inner circle, you are a trusted advisor and a virtual extension of our team. You also bring a level of insight and expertise that only our valued customers can offer, and we do not take that for granted. After all, you are the ones we build all our solutions for.

As an Insider you aren't afraid to share your opinion, positive or negative, in order to ensure we're on the right track. Join the Teranet Insiders Community today.



**Click Here or
Scan to Join!**

Thanks to the value feedback from our Teranet Insider's Community, we have gained insights on the following topics:



Topics for the
Market Insight
Forum



AVM Range



Hood Q
Reports &
Enhancements



Buyer Mobility Report/
Residential Relocation
Reports



GeoWarehouse
Training Curriculum



Imagery
Partners
and AI tools

Introducing TeraIntelligence

Elevated market insights from Teranet

We connect customers to reliable data and authoritative insights through our Market Insight Reports. These reports deliver comprehensive insights into the real estate market in Ontario derived through our data analytics team's analysis of sales and mortgage registration activity in the Ontario Land Registry. Previous editions have explored trends related to multi-property and first-time homebuyers, the impact of Covid-19 on the real estate market, activity on title across the province of Ontario, and much more.

This new market intelligence platform features monthly data spotlights and quarterly insight reports so that you can keep a pulse on what's going on in the real estate market.

Visit TeraIntelligence
to experience our
elevated market insights
experience today.

teraintelligence.teranet.ca



Want to stay up to date on GeoWarehouse?

Visit the blog for more information.



Stay in touch!



Click Here or Scan to Follow Us on Facebook

Support:

Email - geowarehouse.support@teranet.ca

Phone - 416.360.7542

Toll Free - 1.866.237.5937

Training:

Email - geowarehouse.training@teranet.ca

Phone - 416.360.5263

The New Era of Real Estate is Here

REALM™ will transform how you do business.

REALM™ is a modernized singular Multiple Listing Platform (MLP) platform featuring a mobile first, end-to-end intuitive mobile user experience for real estate professionals.

This customer-centric platform is designed specifically for Real Estate Sales Professionals.

1

A Multiple Listing Platform (MLP) System combined with land registry data and a secure, real-time communication portal all in one environment.

2

Manage your listings, conduct market research and gain property intelligence all from desktop or your mobile device. **It's built for today's mobile agent.**

3

With limitless potential integrations, you can go from doing research to communicating with clients and colleagues to facilitating offers seamlessly.

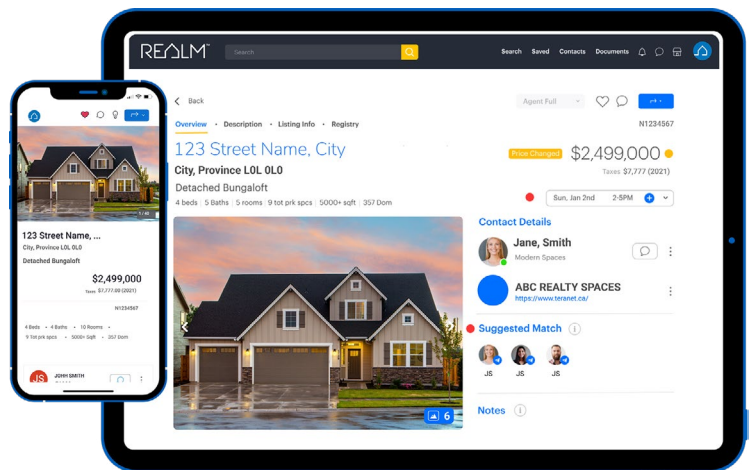

Book a REALM™ demo for your Board of Directors today.

Paul McGowan - paul.mcgowan@teranet.ca

Chris Butler - chris.butler@teranet.ca

Theresa Corindia - theresa.corindia@teranet.ca

Grant Anderson - grant.anderson@teranet.ca



geowarehouse.ca